



# VITA CONCORD VERTICAL

Vita Series

**50  $\Delta t$**

(75/65/20°C)

**SINGLE**

| Height mm   | Length mm | Elements | Stelrad UIN | Watts | Heat output Btu/hr |
|-------------|-----------|----------|-------------|-------|--------------------|
| <b>1800</b> | 444       | 6        | 448340      | 852   | 2907               |
|             | 592       | 8        | 448341      | 1136  | 3876               |
|             | 740       | 10       | 448342      | 1420  | 4845               |
| <b>2000</b> | 444       | 6        | 448343      | 942   | 3214               |
|             | 592       | 8        | 448344      | 1256  | 4286               |
|             | 740       | 10       | 448345      | 1570  | 5357               |

**DOUBLE**

| Height mm   | Length mm | Elements | Stelrad UIN | Watts | Heat output Btu/hr |
|-------------|-----------|----------|-------------|-------|--------------------|
| <b>1800</b> | 444       | 6        | 448640      | 1254  | 4279               |
|             | 592       | 8        | 448641      | 1672  | 5705               |
|             | 740       | 10       | 448642      | 2090  | 7131               |
| <b>2000</b> | 444       | 6        | 448643      | 1386  | 4729               |
|             | 592       | 8        | 448644      | 1848  | 6306               |
|             | 740       | 10       | 448645      | 2310  | 7882               |

$\Delta t50$  is the UK's industry standard for heating outputs, which has an operating temperature of 75/65/20°C. If you have a low temperature heat source you may wish to consider  $\Delta t40$  or  $\Delta t30$  output (see your installer or system designer or download from [www.stelrad.com](http://www.stelrad.com)).

For EN442 data, technical and installation information please visit our website: [www.stelrad.com](http://www.stelrad.com) and search product downloads.

# VITA CONCORD VERTICAL

Vita Series

## WALL MOUNTING INFORMATION

All dimensions in mm.

| Type     | From back of radiator to wall |        | From wall to centre of connections |        | From front of radiator to wall |        |
|----------|-------------------------------|--------|------------------------------------|--------|--------------------------------|--------|
|          | mm                            | inches | mm                                 | inches | mm                             | inches |
| Vertical | 24                            | 0.98   | 43                                 | 1.69   | 71                             | 2.80   |

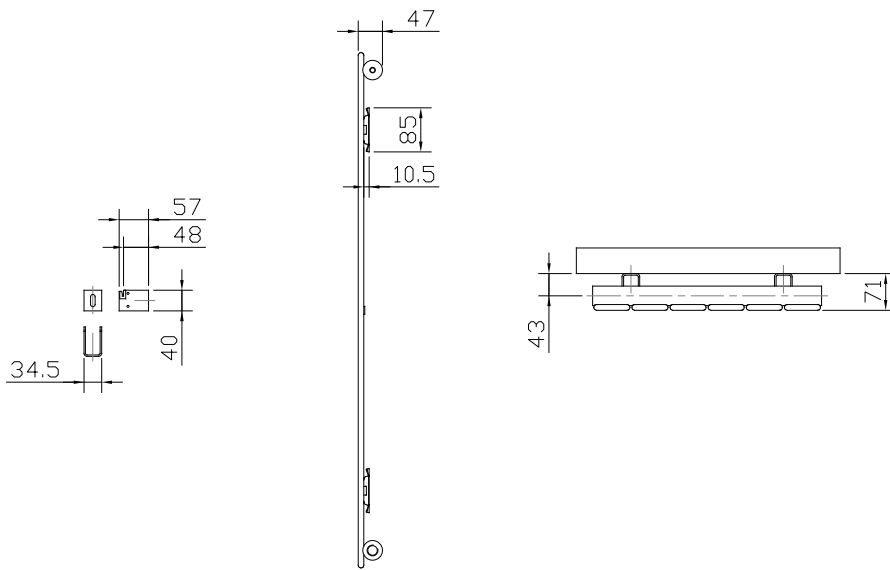

## FIXING POSITIONS

All dimensions in mm. Inches in brackets.

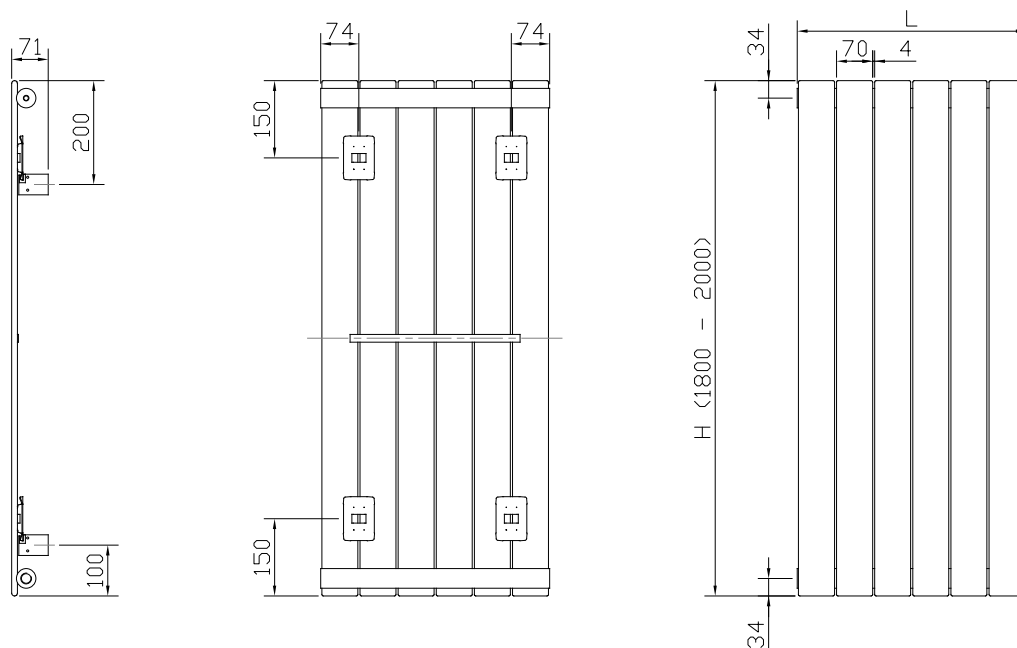

## CONNECTIONS

Each radiator comes with 1/2" inlet connections as standard.

# VITA CONCORD VERTICAL

Vita Series

## EN 442 CERTIFICATION DATA - CETIAT TESTED IN ACCORDANCE WITH BS EN 442

| Type                                    | Vertical |      |
|---|----------|------|
|   | 1800     | 2000 |
| Height                                  | 1800     | 2000 |
| W/m at 75/65/20                         | 1846     | 2041 |
| n-coefficients                          | 1.31     | 1.31 |
| Heated surface area (m <sup>2</sup> /m) | 4.01     | 4.42 |
| Weight (kg/m)                           | 44.2     | 49.4 |
| Water contents (l/m)                    | 14.3     | 16.9 |
| Wall to tap centre (mm)                 | 43       | 43   |

## STEEL THICKNESS 1.25mm

## PIPING INSTRUCTIONS

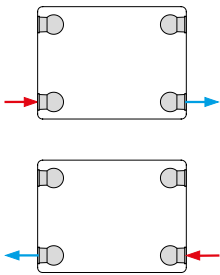

## PRESSURE DROPS

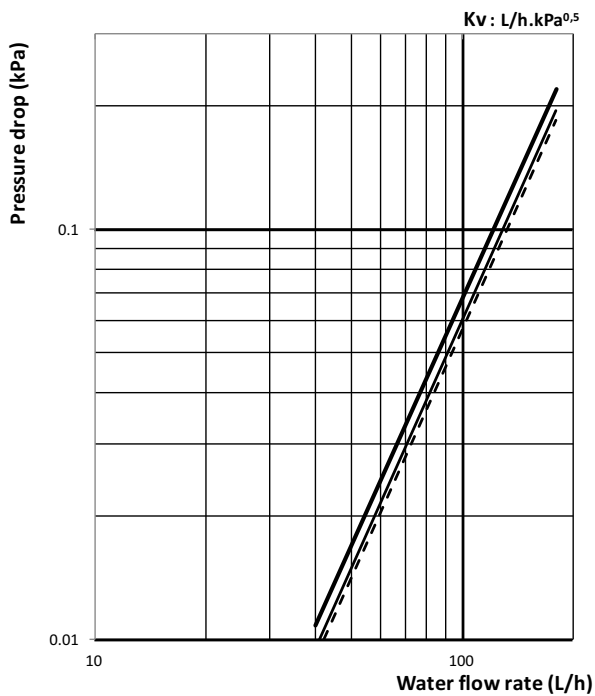

- Vertical 1800/2000 10 elts - Kv=383
- Vertical 1800/2000 8 elts - Kv=408
- - Vertical 1800/2000 - 6 elts - Kv=419