

STAINLESS STEEL INSTALLATION GUIDE



ELECTRIC DRILL &
DRILL BIT



SPIRIT LEVEL



CORDLESS SCREWDRIVER &
CROSS POINT
SCREWDRIVER
(BIT PH2)



METRIC RULER



HAMMER



STEP LADDER
(FOR HIGH PRODUCTS)



ALLEN KEY

Installation instructions are for the below products

Stelrad Stainless Steel Towel Rail, Stelrad Como Stainless Steel Towel Rail and Stelrad Lecco Towel Rail.

CONTENT OF MOUNTING SET

Decorative Cap (x2)
(Only for mirror finished products)



Blind Plug (x1)



Air Vent (x1)



Wall Mounting Screw (x4)



Wall Mounting Bracket (x4)



SPECIAL CASES

*Mounting elements, Decorative cap (A) and Blind Plug (B) are NOT included and the installation set for the Stelrad Lecco Towel Rail.

* X3 pieces of Wall Mounting Screw (C), Wall Mounting Bracket (D), Wall Plug (E) and Setscrew (F) are included in the installation set for the Lecco Towel Rail

Wall Plug (x4)



Setscrew (x4)



INSTALLATION

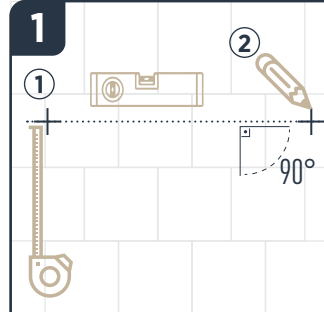

1- Adjust the height of your radiator by using a metric ruler.

2- Set the location of your radiator as desired, align with the ground by using a spirit level and mark the position of the wall mounting brackets.

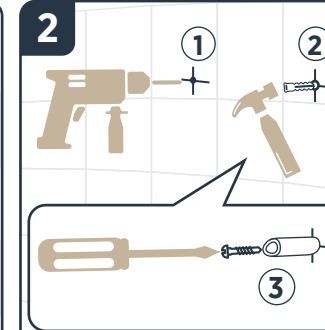

1- Drill holes (Ø 10 mm) into the spots you have marked.

2- Nail the wall plugs (E) in the holes by using a hammer.

3- Screw the wall mounting brackets all the way to the holes with the help of a screwdriver.

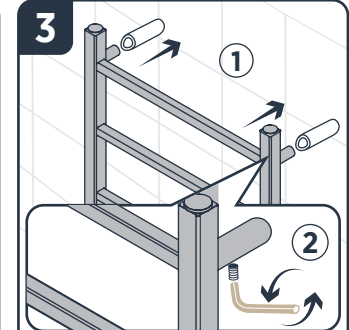

1- Place your radiator into the wall mounting brackets (D).

2- Insert the setscrews (F) into the slots on the mounting brackets (D), adjust the distance between the wall and your radiator then tighten the setscrews by using an Allen key (M3).



WARNING

- Place your radiator at least 12.5 cm above the floor.
- Provide insulation by wrapping PTFE tape on the treads before installing the valves.
- Apply silicone seal fluid to all treaded parts containing o-rings.
- Connect your radiator to the utilities after following all the installation steps in the manual.
- After connecting to the utilities, do not forget to discharge the trapped air inside the radiator.

www.stelrad.com

