

HOME

SERIES



Conno

BRINGING RADIATOR STYLE INTO UK HOMES

COMO

50 Δ t

(75/65/20°C)

STRAIGHT

Height mm	Length mm	Stelrad UIN	Watts	Heat output Btu/hr
750	500	720001h	247	843
1000	500	720002h	306	1044
1200	500	720003h	341	1164
1500	500	720004h	421	1437

Δ t50 is the UK's industry standard for heating outputs, which has an operating temperature of 75/65/20°C. If you have a low temperature heat source you may wish to consider Δ t40 or Δ t30 output (see your installer or system designer or download from www.stelrad.com).

For EN442 data, technical and installation information please visit our website: www.stelrad.com and search product downloads.

COMO

WALL MOUNTING INFORMATION

All dimensions in mm.

TOOLS REQUIRED FOR INSTALLATION



ELECTRIC DRILL & DRILL BIT



SPIRIT LEVEL



CORDLESS SCREWDRIVER (BIT PH2)



& CROSS POINT SCREWDRIVER



METRIC RULER



HAMMER



STEP LADDER (FOR HIGH PRODUCTS)



ALLEN KEY

INSTALLATION INSTRUCTIONS

Place your radiator at least 12.5 cm above the floor.

Provide insulation by wrapping PTFE tape on the threads before installing the valves.

Apply silicone seal fluid to all treaded parts containing o-rings.

Connect your radiator to the utilities after following all the installation steps in the manual.

After connecting to the utilities, do not forget to discharge the trapped air inside the radiator.

Decorative Cap (x2)
(Only for mirror finished products)

A



Blind Plug (x1)

B



Wall Mounting Screw (x4)

C



Wall Mounting Bracket (x4)

D



Wall Plug (x4)

E



Setscrew (x4)

F



Air Vent (x1)

G

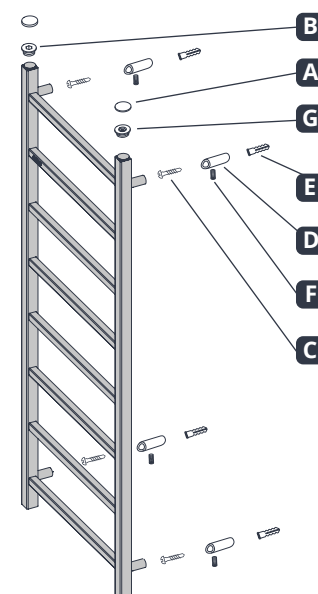

INSTALLATION INSTRUCTIONS FOR THE STAINLESS STEEL TOWEL RAIL

1

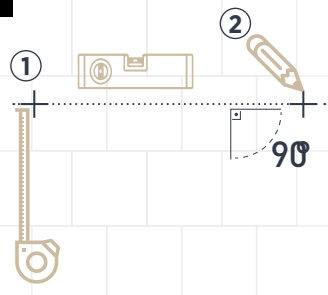

1- Adjust the height of your radiator by using a metric ruler.

2- Set the location of your radiator as desired, align with the ground by using a spirit level and mark the position of the wall mounting brackets.

2

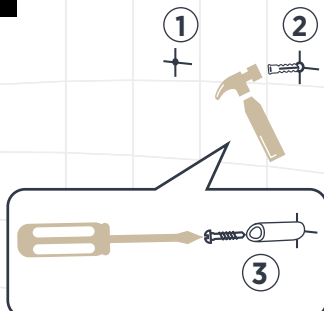

1- Drill holes (Ø 10 mm) into the spots you have marked.

2- Nail the wall plugs (E) in the holes by using a hammer.

3- Screw the wall mounting brackets all the way to the holes with the help of a screwdriver.

3

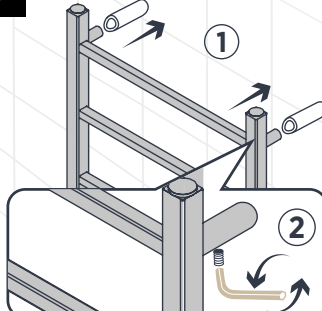

1- Place your radiator into the wall mounting brackets (D).

2- Insert the setscrews (F) into the slots on the mounting brackets (D), adjust the distance between the wall and your radiator then tighten the setscrews by using an Allen key (M3).