

# HOME

SERIES



Column  
Concept

## 50 $\Delta$ t

(75/65/20°C)

### 3 COLUMN

### 4 COLUMN

Height mm	Length mm	Stelrad UIN	Heat output		Stelrad UIN	Heat output	
			Watts	Btu/h		Watts	Btu/hr
<b>600</b>	624	463133h	790	2,695	463140h	1,054	3,595
	854	463134h	1,094	3,732	463141h	1,460	4,978
	1038	463135h	1,338	4,561	463142h	1,784	6,084
	1268	463136h	1,642	5,598	463143h	2,190	7,467

$\Delta$ t50 is the UK's industry standard for heating outputs, which has an operating temperature of 75/65/20°C. If you have a low temperature heat source you may wish to consider  $\Delta$ t40 or  $\Delta$ t30 output (see your installer or system designer or download from [stelradprofessional.com](http://stelradprofessional.com)).

Due to production tolerances, the length of the product and therefore the tap centres could contain a variation of +/- 1.5% of the overall stated length.

For EN442 data, technical and installation information please visit [stelradprofessional.com](http://stelradprofessional.com) and search product downloads.

Floor supporting brackets are available.

#### TUBE DIMENSIONS – 3 COLUMN

25mm round tubes.

Dimensions are in millimeters (mm)

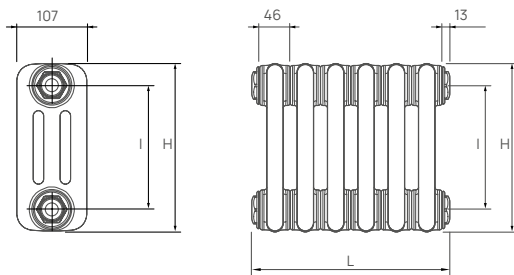

H: height  
I: pipe centre (H-70)  
L: lengths with fitted connections elements x 46 + 26

#### TUBE DIMENSIONS – 4 COLUMN

25mm round tubes.

Dimensions are in millimeters (mm)

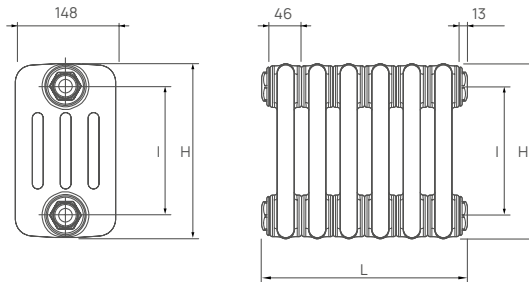

H: height  
I: pipe centre (H-70)  
L: lengths with fitted connections elements x 46 + 26

#### EN 442 CERTIFICATION DATA - CETIAT TESTED IN ACCORDANCE WITH BS EN 442

Type	3 Columns	4 Columns
Height	600	600
W/m at 75/65/20	1322	1763
n-coefficients	1.26	1.27
Weight (kg/m) - Elements	28.26	39.13
Water contents (l/m)	21.74	26.08
Wall to tap centre (mm)	84 / 94	104 / 114

#### CONNECTIONS

Each radiator comes with 1/2" inlet connections as standard.



WARRANTY



IN STOCK

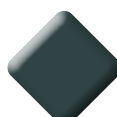

ANTHRACITE  
GREY ONLY