

HOME

SERIES

Column
Vertical
Concept

50 Δ t

(75/65/20°C)

2 COLUMN

Height mm	Length mm	Stelrad UIN	Watts	Heat output Btu/hr
1800	440	463155h	1,152	3,928
2000	440	463157h	1,278	4,358

Δ t50 is the UK's industry standard for heating outputs, which has an operating temperature of 75/65/20°C. If you have a low temperature heat source you may wish to consider Δ t40 or Δ t30 output (see your installer or system designer or download from www.stelrad.com).

For EN442 data, technical and installation information please visit our website: www.stelrad.com and search product downloads.

TUBE DIMENSIONS - 2 COLUMN

25mm Vertical round tubes.

Dimensions are in millimeters (mm)

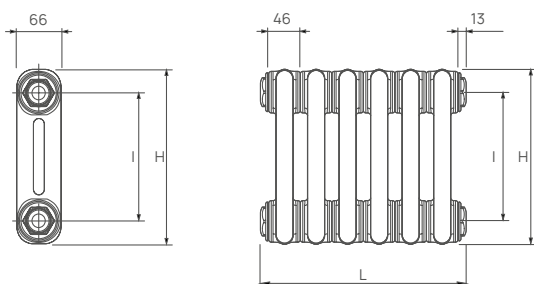

H: height

I : pipe centre (H-70)

L : lengths with fitted connections elements x 46 + 26

EN 442 CERTIFICATION DATA - CETIAT TESTED IN ACCORDANCE WITH BS EN 442

Type	2 Columns	
Height (mm)	1800	2000
W/m at 75/65/20	2783	3087
n-coefficients	1.32	1.32
Weight (kg/m)	56.52	63.04
Water contents (l/m)	34.78	36.96
Wall to tap centre (mm)	63 / 73	63 / 73

CONNECTIONS

Each radiator comes with ½" inlet connections as standard.



WARRANTY



IN STOCK



ANTHRACITE
GREY ONLY